

Hilka

82950010

10 TONNE BENCH TOP SHOP PRESS



ASSEMBLY & OPERATION

PLEASE RETAIN THIS LEAFLET
FOR FUTURE REFERENCE

Parts Guide

Parts no	Description	QTY	Parts no	Description	QTY
01	Pressure Gauge	1	12	Pad Plate	2
02	Nylon Ring	1	13	Press Platform	1
03	Ram	1	14	Under Round Nut	1
04	Hydraulic Hose	1	15	Bottom Plate	1
05	Serrated Saddle	1	16	Up Round Nut	1
06	Hand Pump	1	17	Frame	1
07	Blot M10 x 25	4	18	Washer	3
08	Angle Steel	2	19	Blot M8 x 159	3
09	Rod	2	20	Top Plate	1
10	Washer	6	21	Blot M10 x 110	2
11	Nut M10	6			

Operation

1. Check all parts and condition, if there is any part broken, stop using it and contact your supplier immediately.
2. Before first use, purge away air from the hydraulic system. Open the release valve by turning anti-clockwise. Pump several full strokes to eliminate any air in the system.
3. Place the pad plate (12) on press platform (13), then insert workpiece onto the pad plate
4. Close the release valve by turning it clockwise until it is firmly closed
5. Pump the handle until serrated saddle nears workpiece
6. Align workpiece and ram to ensure center-loading
7. Pump the handle to apply load onto workpiece
8. When work is done, stop pumping the handle, slowly and carefully remove load from workpiece by turning the release valve anti-clockwise in small increments
9. Once ram has fully retracted, remove workpiece from bed frame

Assembly

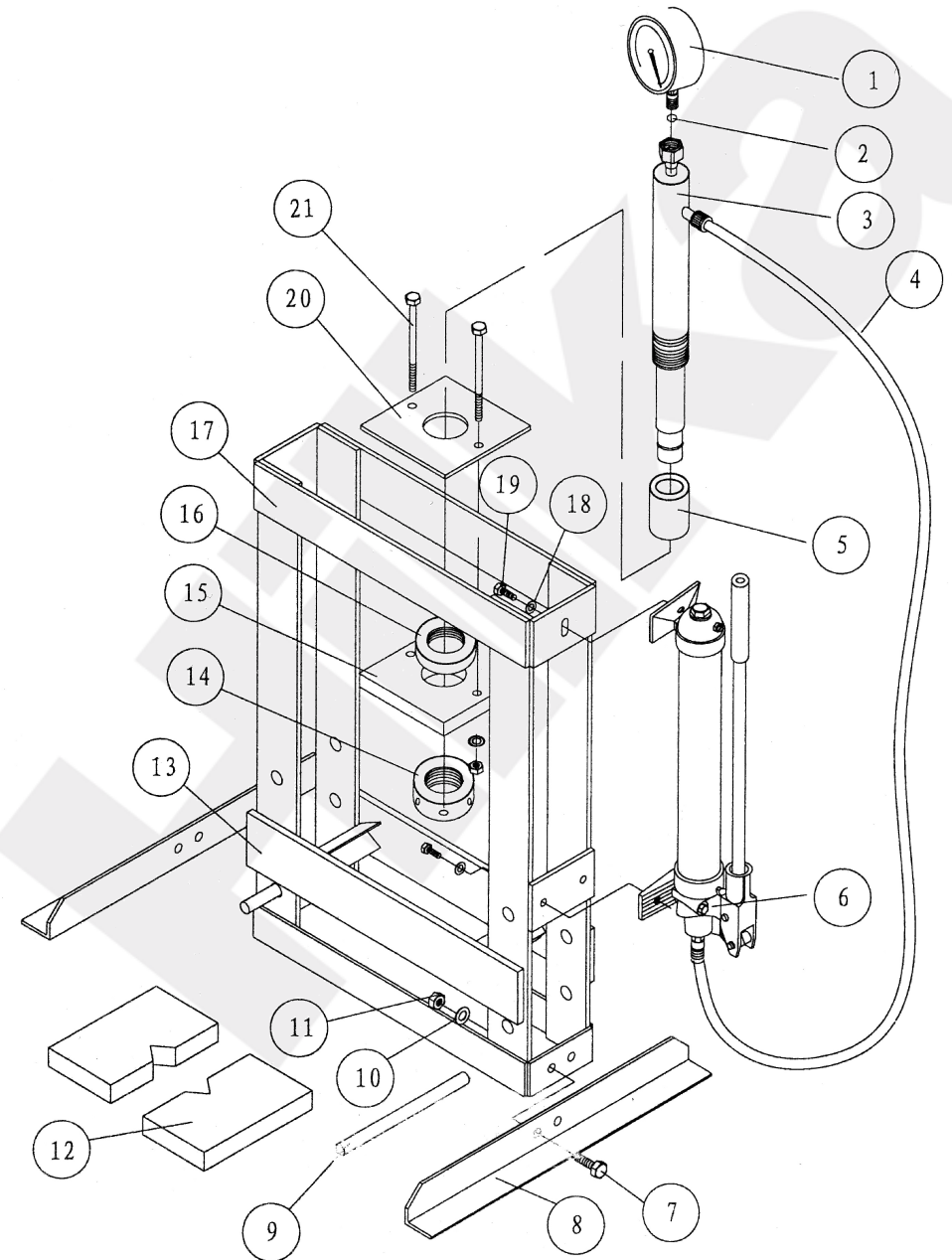

Safety Advice



Steel and other materials can shatter, so always use protective eyewear



Bolt the press to the bench if it is to be used on bulky or unstable items.



Do not use press to compress springs or any other item that could disengage and cause a potential hazard.

Maintenance

1. Clean the outside of the press with dry, clean and soft cloth and periodically lubricate the joints and all moving parts with a light oil as needed.
2. When not in use, store the press in a dry location with ram and piston fully retracted.
3. When press efficiency drops, purge the hydraulic system to eliminate any air in the system (see operation guide)
4. Check the hydraulic oil: remove the oil filler nut on the pump and if required fill with high quality hydraulic jack oil as necessary, then replace the oil filler nut. Purge away air from the hydraulic system

Hilka

Hilka Tools (UK) Ltd
Roebuck Road
Chessington
KT9 1EU

t. 0208 391 7570
f. 0208 391 7575
e. sales@hilka.co.uk
w. www.hilka.co.uk