

RAC

1800W Pressure Washer

RACHP189



Waste electrical products should not be disposed of with household waste.
Please recycle where facilities exist.



Check with your local authority or retailer for recycling advice.

SAFETY AND WARNING INFORMATION

General Safety Rules

WARNING: Read the instructions fully before using the product for the first time. Failure to follow the instructions may result in fire, electric shock and or serious injury.

We recommend the user wears safety equipment during use.

We recommend the product be used with a RCD (Residual Current Device).

Please Retain These Instructions For Future Use And Referral

- This appliance is not intended for use by persons (including children) with reduced physical, sensory or mental capabilities, or lack of experience and knowledge, unless they have been given supervision or instruction concerning use of the appliance by a person responsible for their safety.
Children should be supervised to ensure that they do not play with the appliance.
- When operating the unit in high pressure mode the lance may cause kickback. Therefore please ensure that you hold the spray gun firmly. When using the unit we recommend that other people are at least 10m away from the working area.
- High-pressure jets can be dangerous if misused. The jet MUST NOT be directed at yourself, other people, animals, live electrical equipment or the pressure washer itself. The trigger gun safety lock prevents the trigger from accidentally being engaged. This safety feature does not lock trigger in the 'on' position.
- Do not use the pressure washer if the supply cord or other important parts are damaged (e.g. high pressure lance or hoses). Never carry your pressure washer by the cord.
- Do not disconnect the high-pressure hose whilst the system is under pressure. This system is capable of producing 1600PSI. To avoid rupture and injury, do not operate this pump with components rated less than 1600PSI working pressure (including but not limited to spray guns, hose and hose connections.)
- Do not use acids or flammable liquids in the machine.
- When using a pressure washer always ensure that your water connection is protected by a backflow preventer (as per water byelaws). This will avoid possible contamination of your water supply. Use cold water feed only.
- Protect the unit against freezing, avoid storing the machine where it may be susceptible to frost.
- Prior to starting the pressure washer in cold weather, be sure ice has not formed in any part of the equipment.
- The unit must continuously run with water. Dry running will cause serious damage to the seals.

IMPORTANT: The pressure washer is equipped with an auto stop device. When the trigger is released it will open the power circuit to the motor and cause the pressure washer motor to stop. The motor will resume when the trigger is pulled. The pressure washer is also equipped with a main power ON/OFF switch located on the unit. It should always be moved to OFF position when the pressure washer is not being used.

This product is a class II product-double insulated. No means of grounding (to earth) is provided on this product nor should it be added. Only a qualified person should carry out servicing. If an extension lead is to be used with this product, please ensure:

Use only extension cords that are intended for outdoor use.

Completely unwind the cable from the drum to allow for full current rating of the extension cable.

To reduce the risk of electrocution, keep all connections dry and off the ground.

Do not touch plug with wet hands

Hose: Water supply hose must be at least ½" in diameter with a minimum recommended length of 7.5 meters and be fitted with a suitable coupling that matches the male quick fit connector.

- Use only original spare parts from the manufacturer or approved by the manufacturer.
- **WARNING:** High pressure hoses, fittings and couplings are important for the safety of the appliance.

COMPONENTS



- | | |
|-------------------------------|-----------------------------|
| 1. ON /OFF Switch | 10. Cable holder |
| 2. High pressure outlet | 11. Lance holder |
| 3. Water supply inlet | 12. Soap dispenser |
| 4. High pressure hose | 13. Screws (x4) |
| 5. Quick fit connector (Male) | 14. Fixed brush |
| 6. Rotary brush | 15. Turbo lance |
| 7. Cleaning needle | 16. Patio cleaner extension |
| 8. High pressure lance | 17. Patio cleaner |
| 9. Trigger gun | 18. Top handle |

Technical specification

Rated voltage:	240V ac	Nozzle spray angle:	0-90 degree
Rated power:	1800W	Max output flow rate:	6.6/min
Rated frequency:	50Hz	Cable length:	5 m
Protection class:	II	Hose length:	5 m
Degree of protection:	IPX5	Noise value:	77Lpa dB (A)
Max pressure:	14Mpa	Noise value:	92Lwa dB (A)
Rated pressure:	10Mpa		
Max Inlet pressure:	0.7Mpa		
Vibration:	ah=1.8 m/s		
Max supply water temperature:	0-40°C		

ASSEMBLY



WARNING

Before carrying out any assembly or disassembly of this unit, ensure it is disconnected from the electrical supply.

Assembling your machine

1. Mounting the cable holder

Press the cable holder (10) on to the machine.

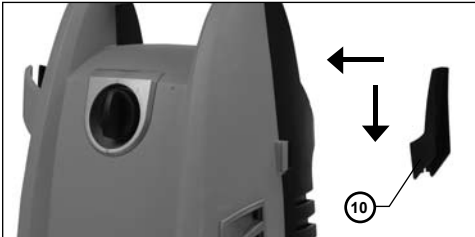

2. Mounting of top handle (models with handle)

Place the top handle (18) on the machine. Secure the handle with screws (13).

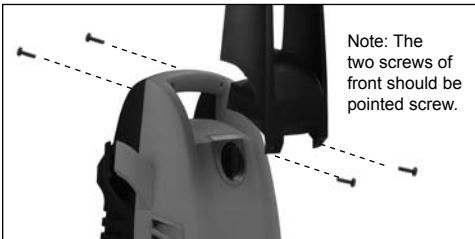

3. Mounting the quick fit connector

Screw the quick fit connector (5) tight on to the water supply inlet (3).

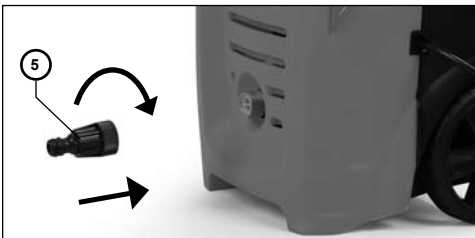

Note: The inlet filter must always be fitted in the

water inlet pipe to filter out sand, limestone and other impurities as these will damage the pump valves.



Caution: Failure to fit the filter will invalidate the guarantee.

4. Connecting the high pressure hose

Screw the high pressure hose (4) on to the high pressure outlet (2).

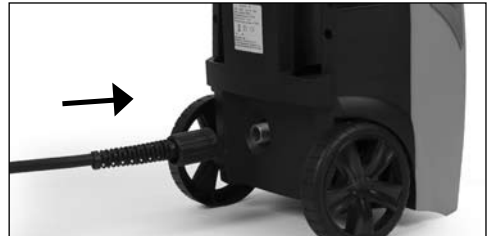

5. Connecting the high pressure hose to the trigger gun.

Screw the high pressure hose (4) on to the trigger gun (9).

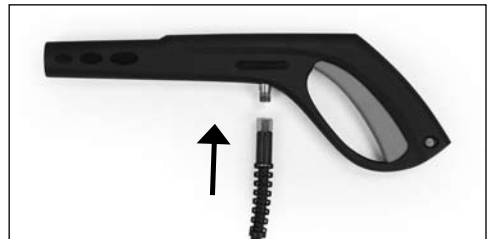

ASSEMBLY (cont)

6. Fitting the high pressure lance

Push the high pressure lance (8) into the trigger gun (9) and turn to lock in.

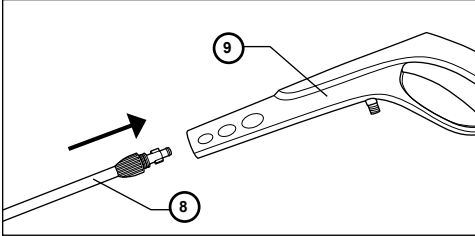

7. Water connection

An ordinary 1/2" garden hose of **min. 5 m** and **max. 25 m** will be suitable.

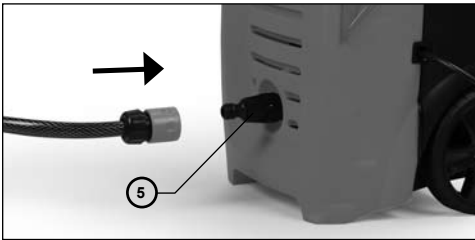

OPERATING INSTRUCTIONS

Note:

Before connecting to the mains power supply please ensure that the ON / OFF switch (1) is in the OFF position and the water supply is connected and is turned on.

WARNING: Running the pressure washer without any water supplied to it will damage the pump.



Instructions for use

- a) With the unit fully assembled, ensure that the unit is switched OFF and is connected to the mains supply and the water supply. Pull the trigger a few times to expel any air trapped in the system.
- b) Ensuring that the trigger is released, switch ON the pressure washer. The unit is now ready to operate by pulling the trigger.

Note:

The motor only runs when the trigger is operated. When the pressure washer is not in use, actuate the trigger gun lock for safety reasons. Switch the unit OFF when not in use for extended periods of time. Never operate the pressure washer without the water supply connected and turned on.



Helpful Hints

Before starting cleaning remove any objects which could create a hazard.

Ensure that all doors and windows are closed (where appropriate).

The adjustable lance allows you to use a variety of spray patterns from a fan to a pencil jet.

When using the pressure washer to clean decking, patios, vehicles, etc., always start by using the fan spray and begin spraying from a minimum 30cm away to avoid damaging the surface of the material to be cleaned.

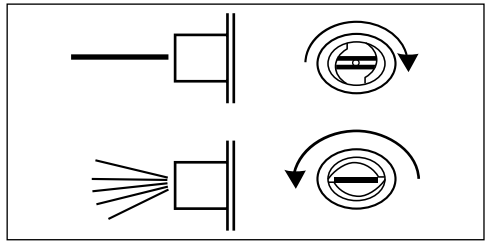

Warning: Always check that NO damage can occur to the items you are intending to clean.

Always use safety wear for your personal protection.

General applications for this product are domestic cleaning tasks: Cars, motorbikes, caravans, and boats

Patio's, fences, garden walls, pathway, driveways – particularly block driveways
Roofs, brickwork and guttering
Garden tools, furniture and barbecues
Animal pens

Brushes

Your RAC pressure washer is supplied with a rotary brush (6) and a fixed brush (14). Both have soft bristles and are ideal for cleaning car bodywork, windows etc.

The brushes connect directly to the Trigger gun (9).



WARNING

- Ensure the brush is clean and free from debris
- Ensure the surface to be cleaned is sound and will not be damaged by the brushing action. Test on an inconspicuous area first
- Any grit or debris on the surface to be cleaned or in the brush can cause damage to that surface. Please ensure both are checked prior to cleaning.

Patio Cleaner: Assembly

1. Fit the patio cleaner extension (16) onto the patio cleaner (17).
Push and turn to lock the bayonet fitting.

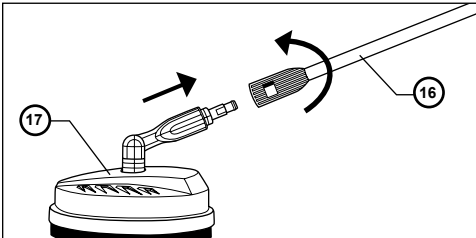

2. Connect the trigger gun (9) on to the patio cleaner extension (16).

Note: All these fittings are bayonet fittings which push in then twist to lock.

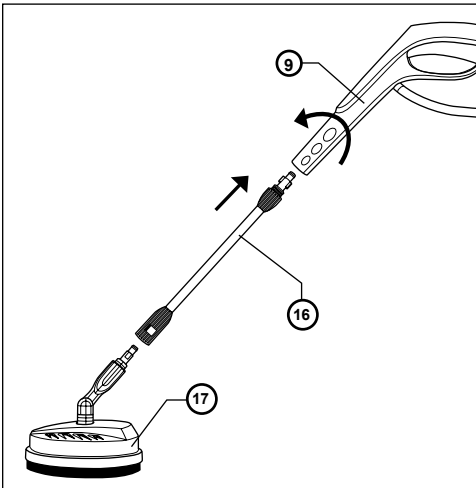

Note: Prior to using the patio cleaner always check that you will not damage the surface area on an inconspicuous test area first.

Turbo Lance

The turbo lance (15), sometimes referred to as a rotary nozzle, is a very effective tool that can significantly reduce cleaning time. It combines the power of a narrow high impact stream and the efficiency of a 25 degree fan pattern. This swirls the narrow high impact stream into a cone shape that cleans a larger area. The turbo lance connects directly to the trigger gun (9).

CAUTION: Since a turbo nozzle uses a narrow high impact stream, only use it in applications where the cleaning surface cannot be damaged by a narrow high impact spray. Note: The turbo nozzle is NOT adjustable and cannot be used to apply detergent.

Soap dispenser



Only use detergents that are specifically made for pressure washers or you could damage the seals/ components inside the pressure washer. Follow the detergent manufacturer's directions for mixing the correct concentrations of detergent to water

Filling

1. Unscrew top of soap dispenser (12) and fill with detergent.
2. Replace top.
3. Remove lance from trigger gun (9).
4. Attach soap dispenser to trigger gun (9).

HOW TO AVOID DAMAGING SURFACES

Damage to cleaning surfaces occurs because the impact force of the water exceeds the durability of the surface. Never use a narrow high impact stream or a turbo/ rotary nozzle on a surface that is susceptible to damage. Avoid spraying windows with a narrow high impact stream or turbo nozzle as this may cause breakage.

The surest way to avoid damaging surfaces is to follow these steps:

1. Before triggering the gun, adjust the nozzle to a wide fan pattern.
2. Place the nozzle approximately 4-5 feet cleaning surface and begin spraying.
3. Vary the fan pattern spray angle and the distance to the cleaning surface until optimum cleaning efficiency is achieved without damaging the surface.

TIPS FOR EXTENDING THE LIFE OF YOUR PRESSURE WASHER

1. Never operate the unit without water.
2. This pressure washer is not designed to pump hot water. Never connect it to the hot water supply – this will significantly reduce the life of the pump.

WARNING

3. Never operate the unit for more than one (1) minute without spraying water. Otherwise, the resulting heat build up will damage the pump.

4. Winter Storage:

For storage during the winter months we recommend the use of a solution of 50/50 mix of antifreeze and water. This will keep the pump from freezing and getting damaged and will protect the internal components.

Method: You will need a length of garden hose and a funnel. Attach the garden hose to the inlet and pour the antifreeze into the unit via the funnel.

Switch the unit on for a few seconds to allow the solution to flow through the system.

Disconnect your pressure washer from the mains power, then pack away in your storage area.

WARNING: Before reusing completely flush the unit out with plain water. Anti-freeze can damage paintwork so you must ensure there is no antifreeze left in the system before using it again.

NOZZLE CLEANING INSTRUCTIONS

A clogged or partially clogged nozzle can cause a significant reduction of water coming out of the nozzle and cause the unit to pulsate while spraying. To clean out the nozzle:

- Turn off and unplug the unit.
- Turn off the water supply and relieve any pressure within the unit by squeezing the trigger 2-3 times
- Separate the lance from the gun.
- Rotate the nozzle to the narrow stream setting. This opens up the fan blades.
- Using the cleaning needle (7) or an unfolded paper clip, insert the needle into the nozzle hole and move it back and forth until the debris is dislodged.

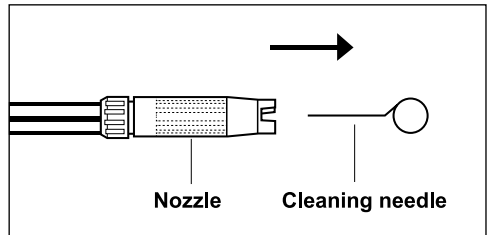

Troubleshooting chart

Symptom	Possible cause (s)	Corrective Action(s)
Pressure washer does not start	<ol style="list-style-type: none"> 1. Unit is pressurized 2. Poor plug connection or faulty outlet socket 3. Extension cord too long or undersized 4. Main voltage supply too low 	<ol style="list-style-type: none"> 1. Squeeze trigger on gun 2. Check plug, socket 3. Remove extension cord 4. Check that main supply voltage is adequate
Pump does not reach necessary pressure	<ol style="list-style-type: none"> 1. Water inlet filter is clogged 2. Pump sucking air from hose connections 	<ol style="list-style-type: none"> 1. Clean water inlet filter 2. Check that connections and locking ring are properly tightened
Fluctuating pressure	<ol style="list-style-type: none"> 1. Pump sucking in air 2. Clogged nozzle 	<ol style="list-style-type: none"> 1. Check that hoses and connections are tight 2. Clear blockage with cleaning needle (see page 7)
Motor stops suddenly	<ol style="list-style-type: none"> 1. Extension cord too long or undersized 	<ol style="list-style-type: none"> 1. Remove extension cord
No detergent suction	<ol style="list-style-type: none"> 1. Using high pressure setting 2. Not enough detergent 	<ol style="list-style-type: none"> 1. Use low pressure setting 2. Add detergent up to min level

Plug fitting

Note: If a moulded plug is fitted and has to be removed take great care in disposing of the plug and severed cable, it must be destroyed to prevent engaging into a socket. If the supply cord is damaged it must be replaced by a qualified person in order to avoid hazard. Your pressure washer is supplied with a fitted plug, however if you should need to fit a new plug follow the instruction below. If in doubt consult a qualified electrician.

IMPORTANT

The wires in the mains lead are coloured in accordance with the following code:

Blue - Neutral, Brown - Live

As the colours of the wires in the mains lead of this appliance may not correspond with the coloured markings identifying the terminals in your plug, proceed as follows:

The wire which is coloured blue must be connected to the terminal which is marked with N

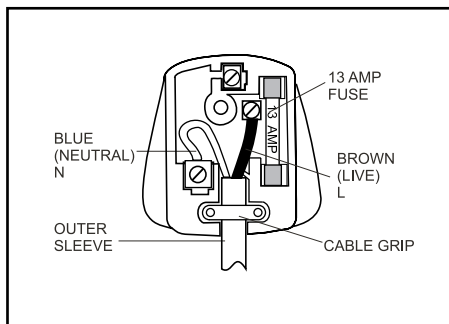

The wire which is coloured brown must be connected to the terminal which is marked with the letter L

No connection is to be made to the earth terminal of the plug. If a 13 AMP (BS 1363/A) plug is used, a 13 AMP fuse must be fitted, or if any other type of plug is used a 13 AMP fuse must be fitted, either in the plug, or adaptor or on the distribution board.



WARNING SYMBOLS

The following warning symbols are to remind you of safety precautions you should take when using this pressure washer

	<p>WARNING: Do not direct the water jet towards other people, animals, the washer itself, its electrical parts, or other electrical equipment.</p>
	<p>WARNING</p>

*If faults cannot be remedied, contact the **Helpline** on **020 8391 6767***

Helpline@hilka.co.uk

GUARANTEE

This product is guaranteed for domestic use for a period of 12 months against faulty manufacture or materials. This guarantee does not affect the statutory rights of the consumer. In the event of any problem occurring please contact our Helpline at the number above for advice. This product is not guaranteed for **HIRE** purposes.

Produced under license for Halco Products Ltd
Booths Hall, Booths Park, Chelford Road,
Knutsford, Cheshire WA16 8QZ England