

challenge[®]

Digital Home Safe

THIS MANUAL CONTAINS IMPORTANT INFORMATION REGARDING THE
OPERATION AND MAINTENANCE OF THE SAFE
COMPLETELY READ AND UNDERSTAND THE MANUAL BEFORE SECURING ITEMS IN THE SAFE
SAVE THIS MANUAL FOR FUTURE REFERENCE

MODELS: T-25E / T-50E

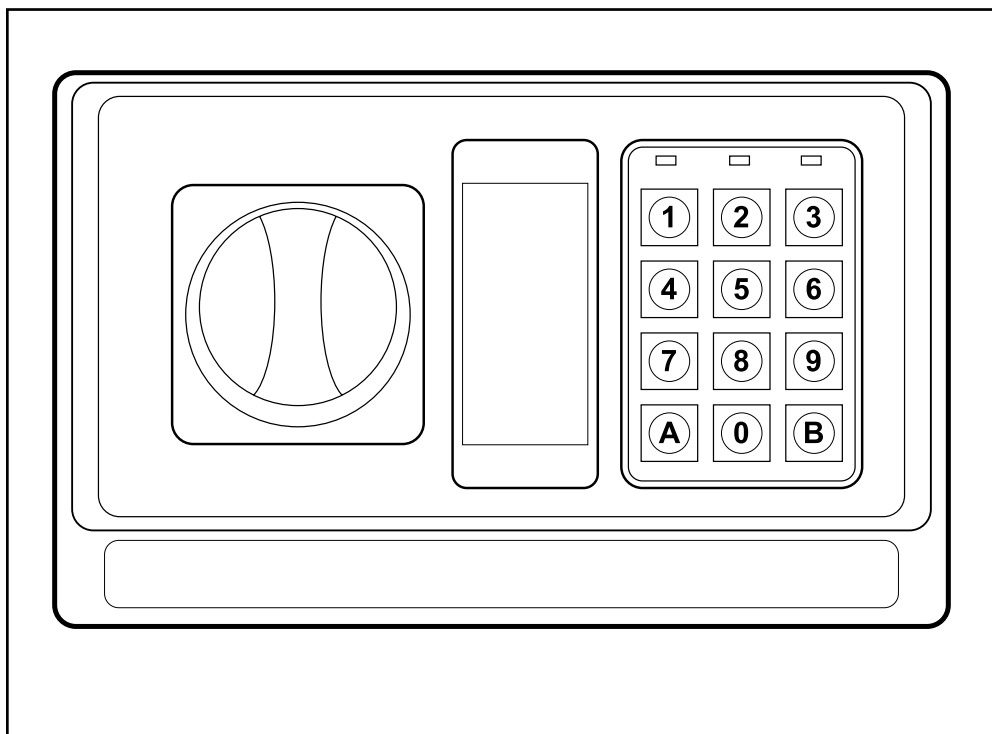

NEVER LOCK YOUR SPARE OVERRIDE KEYS OR THE INSTRUCTION MANUAL IN THE SAFE.
ONCE THE BATTERIES DEplete, YOU WILL NEED TO USE THE KEYS TO OPEN THE SAFE.
SPARE KEYS ARE UNAVAILABLE!



Always Read the Instruction Manual



SAFE DIAGRAM

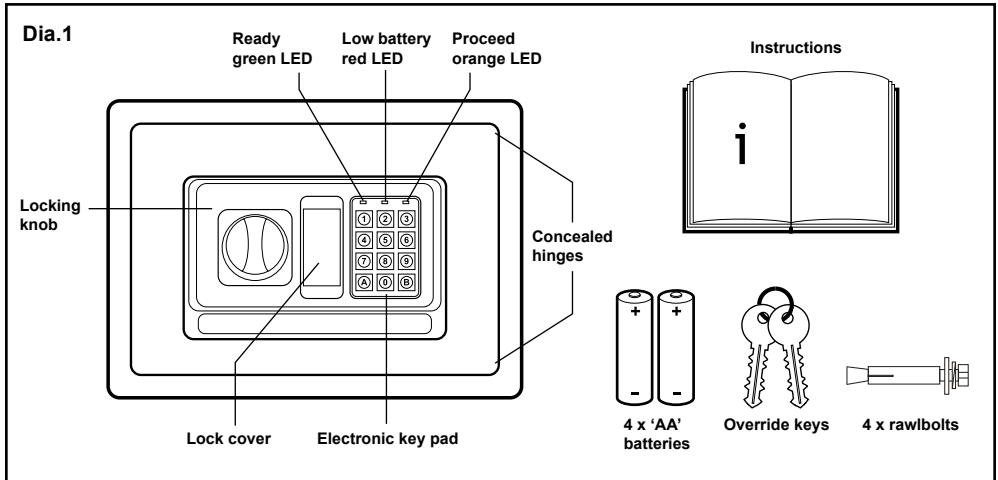

NOTE: This safe is NOT fire proof.

NOTE: This safe has no cash rating.

CONTENTS

- 1 X Instruction book
- 2 X Manual override keys
- 1 X Internal mat
- 4 X 'AA' Batteries
- 4 X Rawlbolts

SPECIFICATION

	T-25E	T-50E
SIZE :	35 (w) x 25 (h) x 25 (d) Cm	35 (w) x 50 (h) x 31 (d) Cm
NET WEIGHT:	9.15Kgs	17.15Kgs
POWER SUPPLY:	4x 'AA' 1.5V Batteries	4x 'AA' 1.5V Batteries
INTERNAL VOLUME:	21.8 Litre	54.3 Litre

IMPORTANT INFORMATION

Note: Please make sure that after you have opened the safe for the first time, you change the PIN, for security reasons.

OPERATING THE SAFE FOR THE FIRST TIME

Use the Manual override key to open the safe.

- Remove the plastic key lock cover (dia 1)
- Insert the override key; turn it anti-clockwise, at the same time turn the locking knob clockwise and pull open the safe.
- See **BATTERY REPLACEMENT**
- Keep the safe door open until you have set the PIN code.

PROGRAMMING YOUR PIN NUMBER (*personal identification number*)

DEFAULT FACTORY PIN: 159

Each time a button is pressed, a beep will be heard and the Orange LED will flash. This is a safety feature so that you will know when the safe is being accessed and cannot be switched off.

Keep PIN Codes in a safe place.

Do not use personal information like birthdays, telephone numbers etc.

- Write down your PIN codes so you do not forget it. (any combination of numbers from 3 to 8 digits)
- With the door open, remove the security cap by unscrewing it, (dia.2).
- Depress the red reset button located at the back of the door.
- Two beeps will be heard and the Orange LED will light.
- You now have 20 seconds to enter your PIN.
- Key in your new PIN.
- Press the "A" or "B" button once.
- Two beeps will be heard and the Orange LED will go out.
- Your PIN has now been set.
- Screw the security cap back onto the red reset button. Ensure you do this for security reasons.

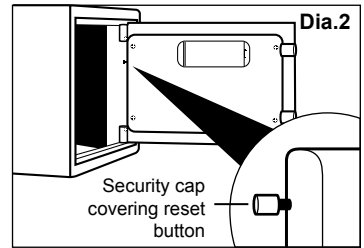

While the door is open familiarise yourself with the door opening procedure, and leave the door open until you are satisfied that you fully understand the opening and closing method. You can re-set the PIN at any time by following the above procedure.

OPENING THE DOOR USING YOUR PIN NUMBER (*personal identification number*)

Each time a button is pressed, a beep will be heard and the Orange LED will flash.

- Enter your PIN number.
- Press the "A" or "B" button.
- Two beeps will be heard and the Orange LED will flash.
- The Green LED will light to indicate that the safe door can be opened.
- You now have 5 seconds to open the door before it will lock again.
- Open the safe door by turning the knob clockwise and pulling it open.



If the Red and Green LED lights simultaneously when the correct PIN is entered, then the batteries **MUST** be replaced immediately before closing the door as this indicates that the batteries are too low.



If an incorrect PIN is entered, the safe will not open, three warning beeps will be heard & the Orange LED will flash and the Green LED won't light. Entering an incorrect PIN three consecutive times will freeze the locking mechanism and keypad for 20 seconds, during which time you will not be able to access the safe. After three more incorrect PIN attempts, the locking mechanism and keypad will freeze for 5 MINUTES during which time you will not be able to access the safe.

OPENING THE SAFE USING THE OVERRIDE KEY

Use the Manual override key to open the safe.

- Remove the plastic key lock cover (dia 1)
- Insert the override key; turn it anti-clockwise, at the same time turn the locking knob clockwise and pull open the safe.

BATTERY REPLACEMENT

1. The digital safe uses four 'AA' type batteries (supplied).
 - Remove the battery cover on the rear of the door (dia 5).
 - Push the catch in and pull out the cover.
 - Install the 4x 'AA' batteries supplied. Ensure correct polarity.
 - Replace the battery cover.
 - Keep the safe door open until you have set the PIN code.



The battery life is approximately one year. Make a note of the battery replacement date; they should last approximately one year. However, we recommend checking the batteries every 6 months just to make sure. If power is removed from the safe the set PIN code will be only remain in its memory for approximately 4 hrs then it will need re-setting.

SECURING YOUR SAFE

ADVICE: WE STRONGLY RECOMMEND THAT YOU SECURE YOUR SAFE TO A WALL OR FLOOR FOR SECURITY REASONS.

You may wish to secure your safe to a fixed part of the house (i.e. stone wall or wooden beam). This can be achieved by using 2 of the 4 rawl bolts supplied in the back of the safe or using the 4 rawl bolts in the base of the safe. Use the holes in the safe to mark where you need to drill. Loosely attach the rawl bolts onto the safe with the nuts and washers provided. Hold the safe over the drilled holes and locate the rawl bolts into these holes (Dia 6). Tighten the nuts from the inside of the safe to secure firmly.

Note : The rawl bolts are packed inside the safe

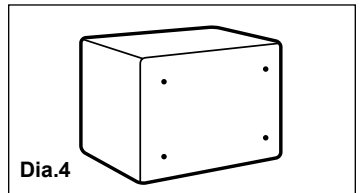
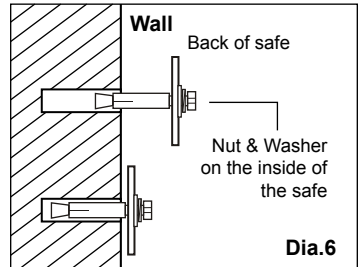
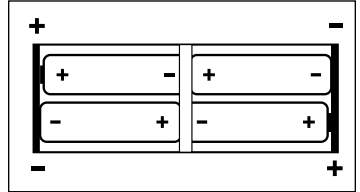
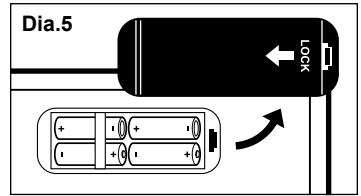

TROUBLE SHOOTING

	PROBLEM	CAUSE	SOLUTION
1	Can I get a replacement key/ extra key?		Replacement keys are not available due to security reasons.
2	The keypad becomes inoperable	Low or depleted batteries	Use override keys and replace batteries.
3	My PIN works and the green light lights, however, the safe won't open	Low batteries. Will operate the keypad but not the lock relay.	Use override keys and replace batteries.
4	I have lost the keys and forgotten the PIN number, can I obtain spare keys.		If the safe cannot be opened properly then you will need to forcibly open it. Please contact our helpline for more information.
5	I am experiencing problems using the back up key; it is unable to slide smoothly into the keyhole.		Spray inside the keyhole with WD40, leave for a few minutes and then try again.
6	We recently changed the batteries in the safe, the safe has reset the code itself, and the code I've been using is no longer valid?	If the batteries are completely depleted for more than a day then the safe will not retain the code.	Try the factory default code 159 or use the override key; then refer to the user manual to reset your original code or to enter a new code.
7	The Red and Green LED lights simultaneously when the correct PIN is entered.	The batteries are depleted.	Immediately replace the batteries.
8	The batteries I bought don't fit the safe?	Batteries can vary in size.	Try another brand.
9	When I use the override key, I can't open the door.		Ensure that you are turning the key anti-clockwise, holding it in that position and then turn the locking knob clockwise to release the catch.



**Always read the
instruction manual**



WARNING!

**NEVER LOCK YOUR SPARE OVERRIDE
KEYS OR THE INSTRUCTION MANUAL
INTO THE SAFE**

SPARE KEYS ARE UNAVAILABLE

HELPLINE Telephone Number 02083 916 767
Alternatively check the Q&A on our website
www.hilka.co.uk/faq.php

HELPLINE

In the unlikely event of a defect occurring please contact our Helpline.
Office hours 9am – 4pm, Monday-Friday. Outside office hours or during peak times you will be
directed to an
answer phone. Please leave your name, a brief description of your enquiry and your number.
One of our operators will contact you as soon as possible.
Telephone Number 02083 916 767
Alternatively check the Q&A on our website www.hilka.co.uk/faq.php

NOTE:

These important safeguards and instructions cannot cover all possible conditions and situations
that may occur. It must be understood that common sense and caution are factors, which cannot
be built into any product. These factors must be supplied by the person using this product.

Manufactured on behalf of Home Retail Group

**489 - 499 Avebury Boulevard,
Central Milton Keynes,
MK9 2NW**